

# High Capacity, High Accuracy Column Type Compression **LOAD CELL**

## CCD-0.1% Series



- Capacities 2tonne to 1000tonne
- Sealed to IP65
- Robust Construction
- Submersible versions available
- Competitively Priced!
- **3 YEAR WARRANTY**

### Options Available

Versions rated to IP67 or IP68 (fully submersible)

Other Ranges Available on request

Equivalents to other manufacturers available

Full range of mounting options available, including

- Custom/Standard Loading Caps

- Custom Mounting Bases

Calibration to BS EN ISO376

Versions available with integral signal amplifiers

Shunt Calibration

Internal Signal Amplifiers

### DESCRIPTION

The CCD-0.1% series are high accuracy column load/force cells designed for use as Reference Standards or in high capacity weighing applications where accuracy is of utmost importance. The CCD-0.1% can be supplied certified by a UKAS laboratory to BS EN ISO376 standards if required. Typical performance is Grade 1 down to 5% of rated capacity.

Applications such as silo weighing, pile force measurement, heavy duty jack levelling systems, press calibration are just some of the applications in which the CCD-0.1% feels at home..

The simple column design and sealed construction of the CCD assures excellent resistance in the most arduous of conditions.

The accuracy of the CCD-0.1% accompanied by keen pricing makes it highly competitive for low and high volume users alike.

Special versions can be manufactured to fit applications where the standard model is not quite suitable, there is also the option of submersible versions and models with on-board signal conditioning.

*Transducer Specialists...*



## **APPLIED MEASUREMENTS LIMITED**

3 MERCURY HOUSE - CALLEVA PARK - ALDERMASTON - BERKSHIRE - RG7 8PN - UK

Tel: (+44) 0118 981 7339 Fax: (+44) 0118 981 9121 email: info@apmeas.co.uk Internet: www.apmeas.co.uk

# SPECIFICATION

Wiring Schematic Diagram

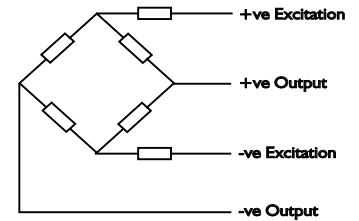

CHARACTERISTICS	CCDT-0.1%	CCDG-0.1%	UNITS
Rated Capacities:	2, 5, 10, 25, 50	100, 200, 500, 1000	tonnes
Rated Output:	2.0 nominal	2.0 nominal (1.5 nom. on 500te>)	mV/V
Total Error:	0.10	0.10	±% of Rated Output
Zero Return:	0.040	0.04	±% of Applied Load
Zero Balance:	2.0	2.0	±% of Rated Output
Temperature Range: Operating	-20°C to +70°C	-20°C to +70°C	°C
Compensated	-10°C to +50°C	+10°C to +50°C	°C
Temperature Effect: On Output	0.010	0.010	% of Applied Load/ °C
On Zero	0.010	0.010	% of Applied Load/ °C
Safe Overload:	150	150	% of Rated Capacity
Ultimate Overload:	300	300	% of Rated Capacity
Excitation: Recommended	10	10	Volts AC or DC
Maximum	15	15	
Bridge Resistance:	700	1400	Ohms
Insulation Impedance:	>500	>500	Megaohms @ 500vdc
Deflection at Rated Capacity:	<0.4	<0.4	mm
Construction:	Stainless Steel	Stainless Steel	
Environmental Protection:	IP65	IP65	
Cable:	4 Metres (standard) 4 Wire Cable	4 Metres (standard) 4 Wire Cable	

All dimensions in mm

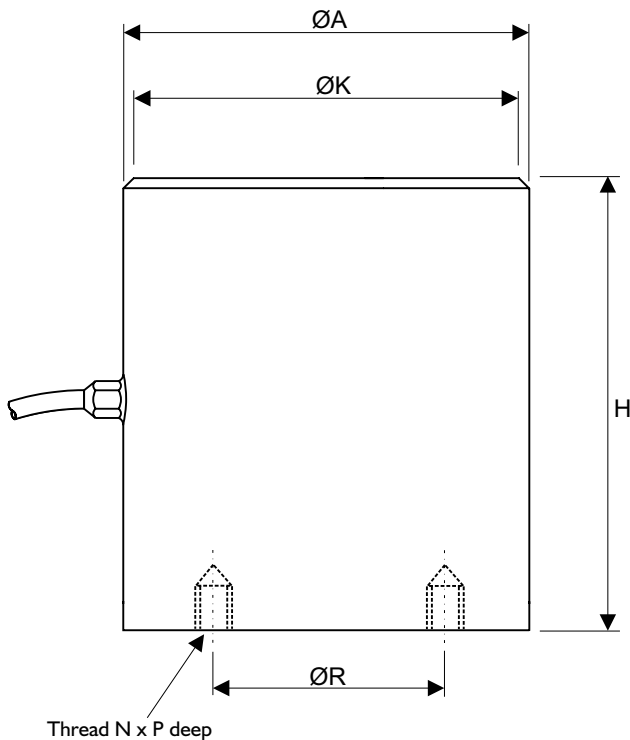

MODEL	Capacity (t)	H	ØA	ØK	Thread N	P	ØR
CCDT	2, 5	40	31	22	M3	5	20
CCDT	10, 25	100	50	39	M4	8	34
CCDT	50	150	100	88	M5	10	70
CCDG	100	185	100	88	M5	10	70
CCDG	200	300	127	113	M6	12	78
CCDG	300/500	325/420	180	160/166	M8	16	140
CCDG	1000	595	300	285	M10	20	220

Typical performance of a CCD-0.1% when certified to BS EN ISO376 is Grade I down to 5%

